

# UTILITY BY OTHERS

-L-  
 PI Sta. 10+65.66  
 $\Delta = 7^{\circ} 26' 21.5" (RT)$   
 $D = 5^{\circ} 40' 22.3"$   
 $L = 131.14'$   
 $T = 65.66'$   
 $R = 1,010.00'$   
 $DS = 18 \text{ MPH}$

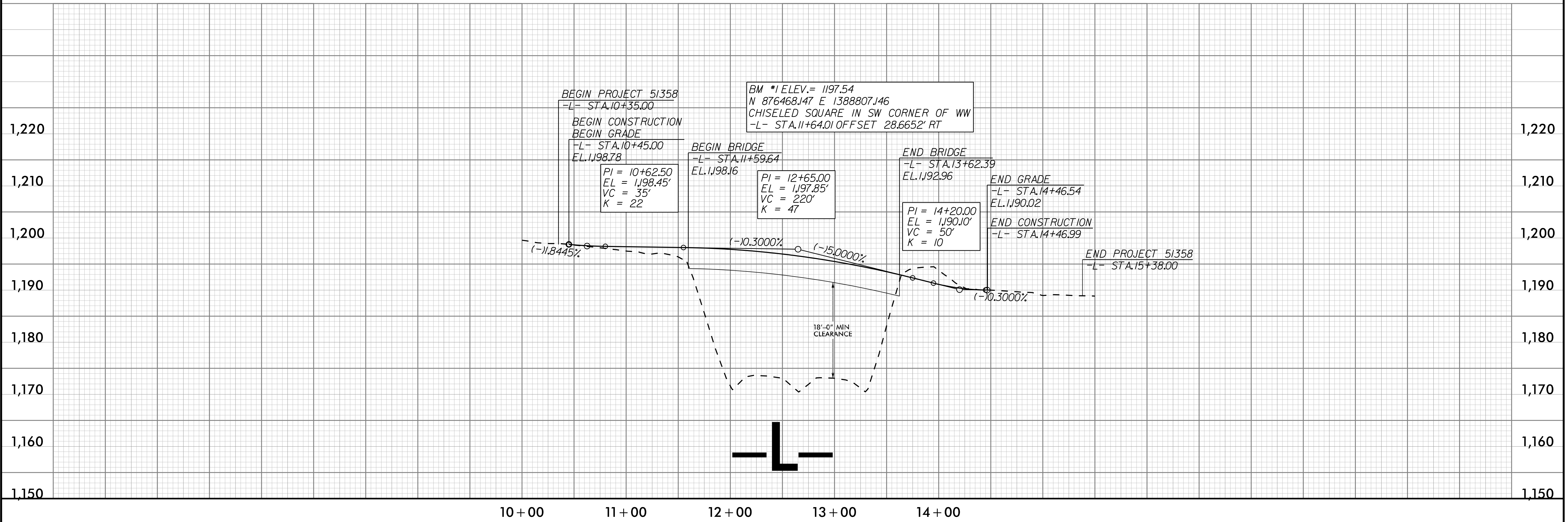

PROJECT REFERENCE NO.	SHEET NO.
51358	UO-1/04
RW SHEET NO.	HYDRAULICS ENGINEER
ROADWAY DESIGN ENGINEER	
<b>DOCUMENT NOT CONSIDERED FINAL UNLESS ALL SIGNATURES COMPLETED</b>	

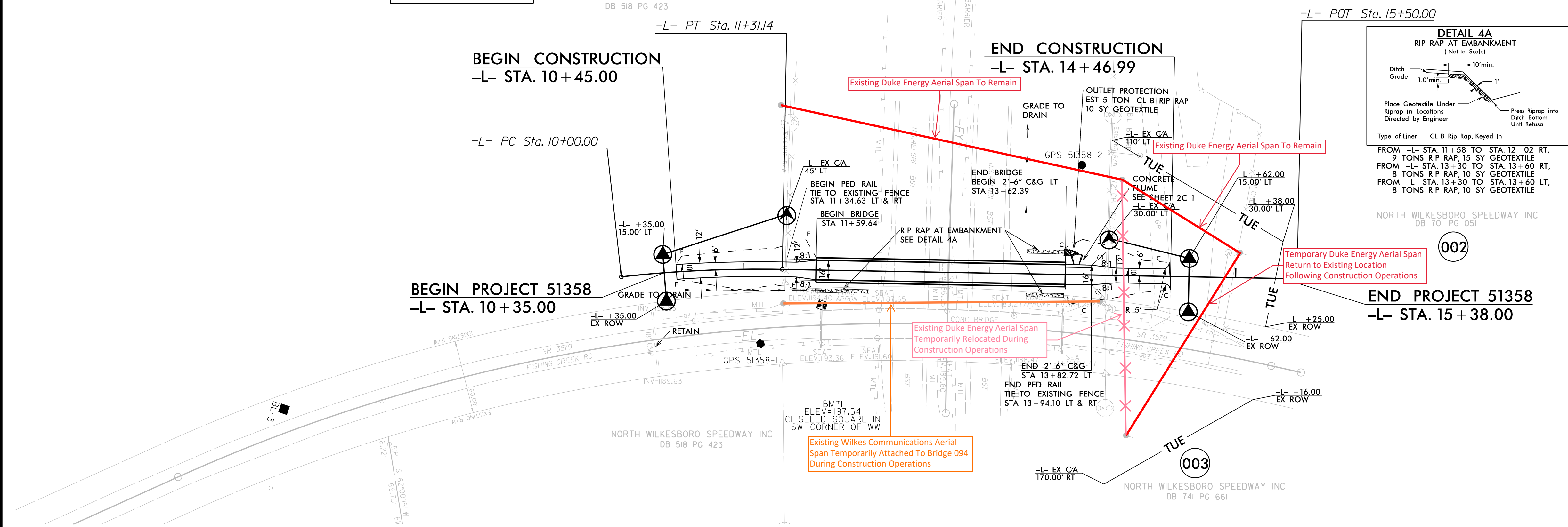

8/17/99  
 8/17/2024  
 c:\pwworking\gannett\gannett\151123\51358\_rdy\_psh04.dgn